

TRAVIS COUNTY

1008

4021

1009

3020

3017

BASTROP COUNTY ELECTION PRECINCT 1009

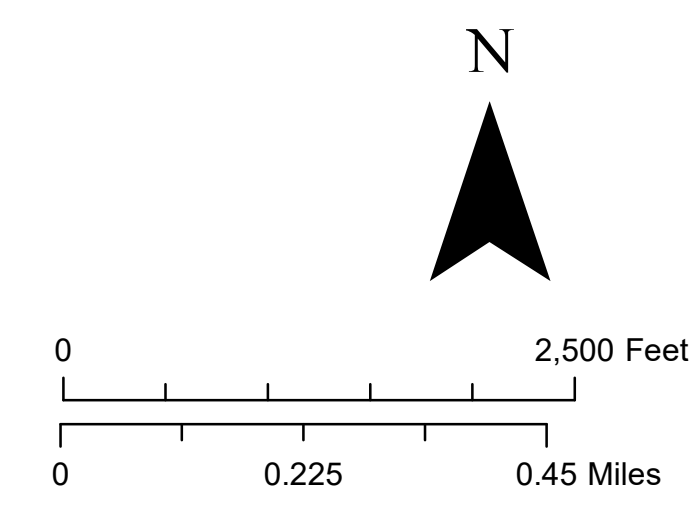

Election Precinct 1009

1001	1006	1011	1016	4021
1002	1007	1012	3017	4022
1003	1008	1013	3018	4023
1004	1009	1014	3019	4024
1005	2010	2015	4025	4026

- Public Highway
- FM Road
- Public Road
- Private Access
- Rail Road
- County Line
- City Limit
- Colorado River
- Lake



DISCLAIMER
Bastrop County provides this map "as is" and assumes no liability for its completeness or accuracy. Information shown on this map is derived from public records that are constantly undergoing change and do not replace a site survey. This product is for informational purposes and may not have been prepared for or be suitable for legal, engineering or surveying purposes. It does not represent an on-site ground survey and represents only the approximate relative location of property boundaries.

Map Title: Bastrop County Election Precinct 1009
Produced By: Bastrop County Information Technology
Author: Julie Sumner
Date: 1/24/2022 at 1:45:51 PM
Bastrop County
Date Expired: 01/25/22

